

Inlet Outside Dimension (O/D): 7.87

Outlet Outside Dimension (O/D): 8.62

Impeller Diameter: 9.84

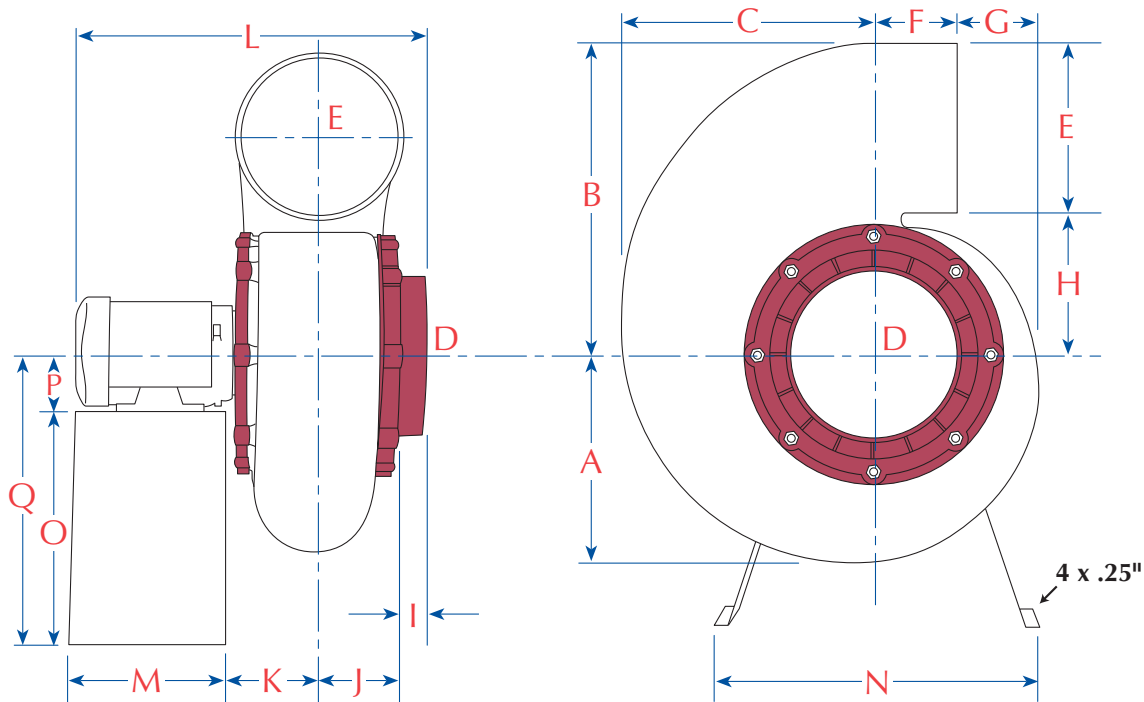

Optional Aluminum and Stainless Steel Impeller Available for 3450 RPM Model

DIMENSIONAL DATA (inches)

A	B	C	D	E	F	G	H	I	J	K	M	N	O
9.76	14.37	12.20	7.87	8.62	4.05	3.62	6.49	1.37	3.74	4.13	7.125	16.25	11.81

L	P	Q	BLOWER TYPE
21.01	3.50	15.31	PLA25ST2P
21.26	3.50	15.31	PLA25XT2P
19.21	3.31	15.12	PLA25SS4P
18.59	3.50	15.31	PLA25ST4P
22.07	3.50	15.31	PLA25XS4P
20.99	3.50	15.31	PLA25XT4P
19.21	3.50	15.31	PLA25SS6P
18.76	3.14	14.95	PLA25ST6P
22.07	3.50	15.31	PLA25XS6P
19.15	3.50	15.31	PLA25XT6P

SHOWN WITH OPTIONAL ROOF UNIT KIT



See Accessories Performance and Dimensional Data Sheets for Roof Unit Kits

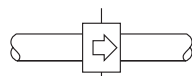

Noise Level
(Ducted inlet/outlet)
Measured at 5 feet.

R.P.M.	LWA dB (A)
1150	48
1725	58
3450	75

PLASTEC 25

CARNES®

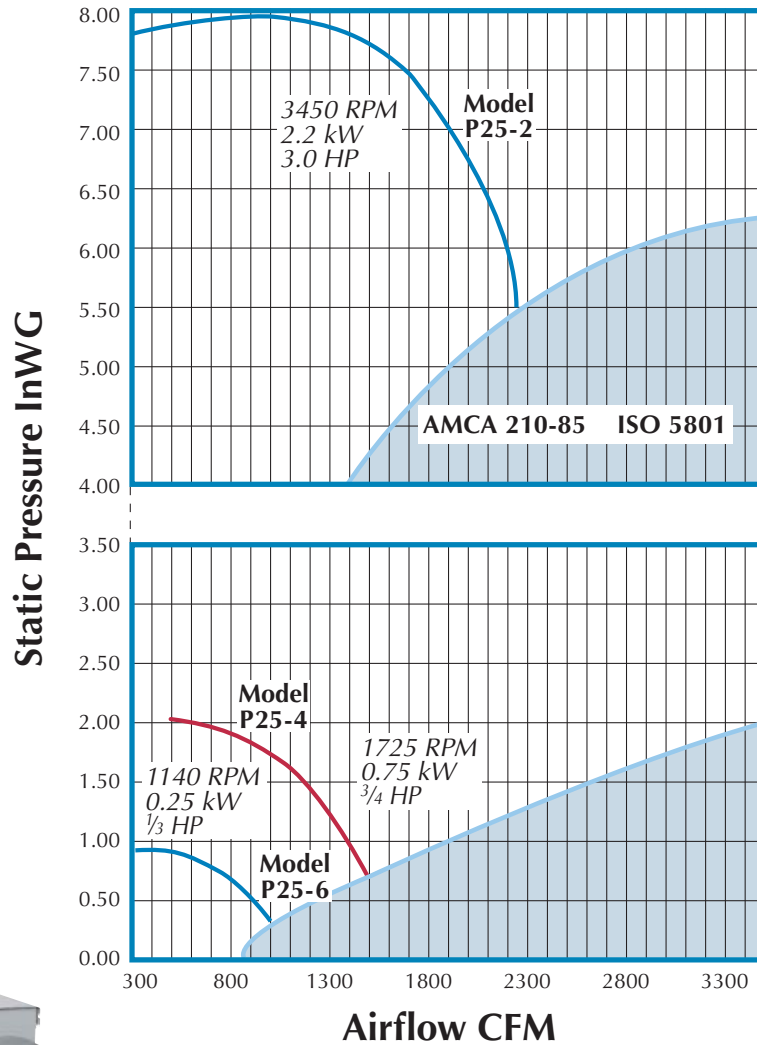

For **Weather Protection** see optional accessory "Weather Hood Enclosed Pedestal" Model WH3, pictured at right. Also see Model WH5 Aluminum Weather Hood pictured at left.



ROTATION AND DISCHARGE FOR CENTRIFUGAL FANS

Standard Position

Optional Field Adjustable Positions



Counter-Clockwise
Up Blast
CCW 360



Counter-Clockwise
Top Angular
Up Blast
CCW 45



Counter-Clockwise
Top Horizontal
CCW 90



Counter-Clockwise
Top Angular
Down Blast
CCW 135



Counter-Clockwise
Down-Blast
CCW 180



Counter-Clockwise
Bottom Angular
Down Blast
CCW 225



Counter-Clockwise
Bottom
Horizontal
CCW 270



Counter-Clockwise
Bottom Angular
Up Blast
CCW 315

Notes:

- (1) Direction of rotation is determined from the drive side of fan. **Standard position is up-blast CCW 360.**
- (2) On single inlet fans, drive side is always considered as the side opposite fan inlet.
- (3) Clockwise available upon request.