

CARNES COMPANY 448 S. Main St., P. O. Box 930040, Verona, WI 53593-0040 Phone: (608)845-6411 Fax: (608)845-6504 www.carnes.com

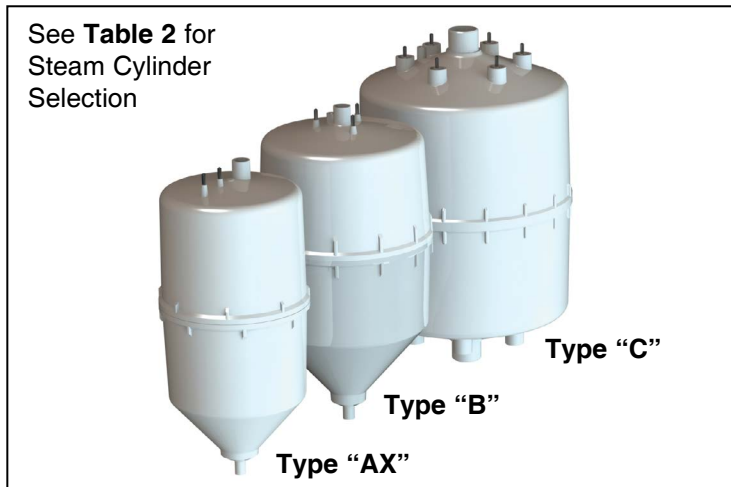
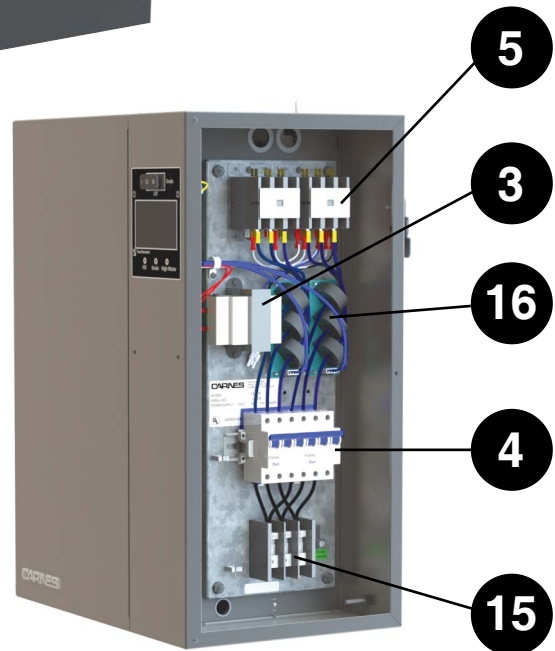
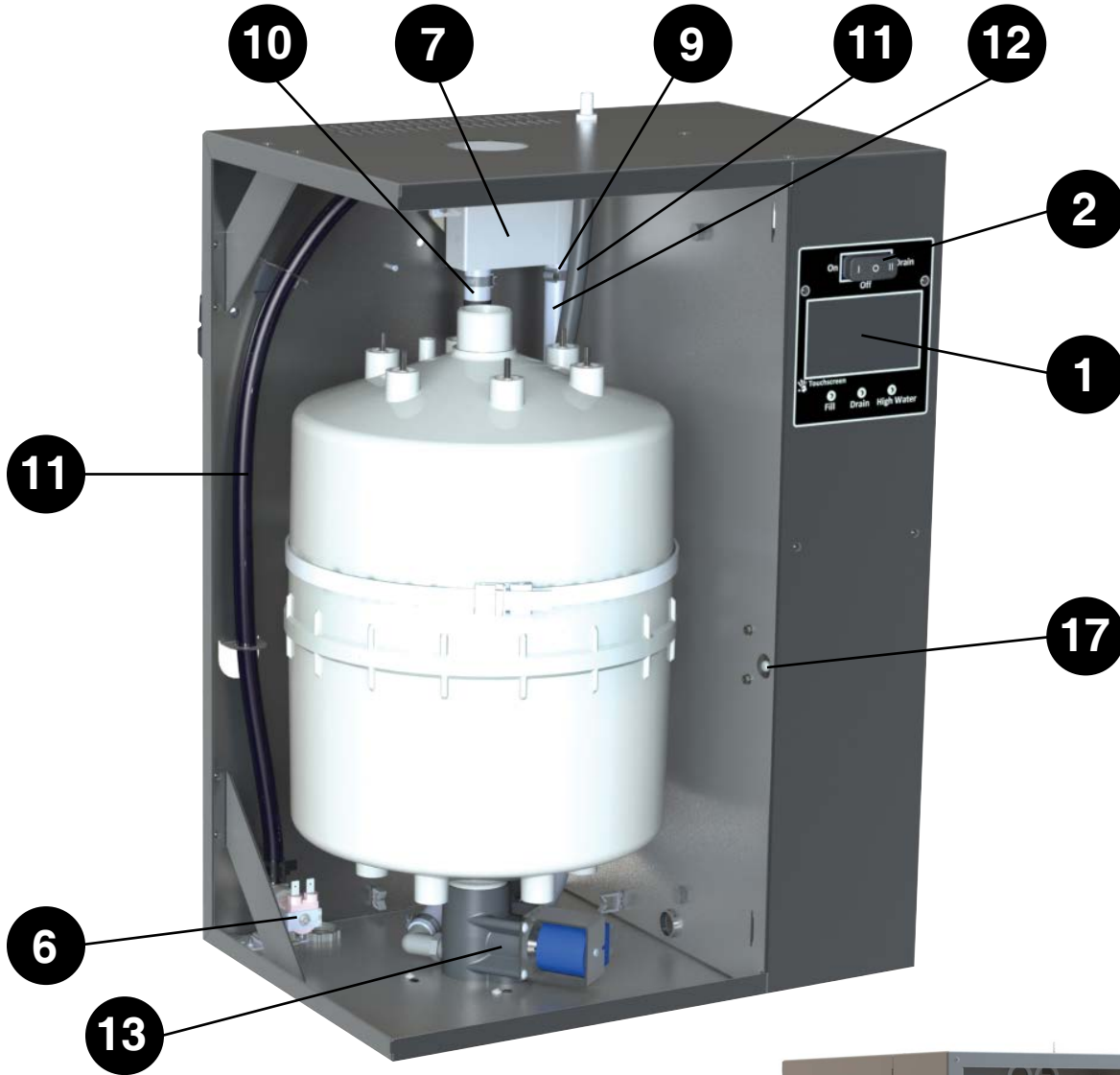

**Table 1**

Item #	Description	Models Where Used	Part #
1	Circuit Board with Touch Screen Display	ALL	SEE TABLE
	"H" Series Retrofit Circuit Board with Touch Screen	ALL "H" Series Models	SEE TABLE
1	CarnesLink Expansion Board	All	H-690-0108
1	CarnesLink Pico Port (Chip)	All "H" and "J" Series	H-999-6120
2	On-Off-Drain Switch	ALL	H-999-7331
3	Power Transformer	ALL	SEE TABLE
4	Circuit Breaker (Optional)	"HT" Models Only	SEE TABLE
5	Contractor	ALL	SEE TABLE
6	Water Fill Valve ("AX"/"B" Cylinder .26GPM)	H_AJ, H_DJ	H-999-7172
6	Water Fill Valve ("C" Cylinder .53GPM)	H_GJ	H-999-7170
6	Water Fill Valve (Dual Cylinder .53GPM)	H_HJ	H-999-7171
7	Molded Fill Cup	ALL	H-690-4135
8	Fill Cup & Cylinder Bracket ("AX" Cylinder)	H_AJ	H-690-1641
8	Fill Cup & Cylinder Bracket ("B" Cylinder)	H_DJ	H-690-1642
8	Fill Cup & Cylinder Bracket ("C" Cylinder)	H_GJ, H-HJ	H-690-1645
9	Metal Hose Clamp	ALL	H-999-7165
10	High Water Sensor Sub Assembly ("AX" / "B" Cylinder)	H_AJ, H_DJ	H-690-1355
10	High Water Sensor Sub Assembly ("C" Cylinder)	H_GJ	H-690-1355
10	High Water Sensor Sub Assembly ("Dual" Cylinder)	H_HJ	H-690-1355
11	Water Fill Tube	ALL	H-999-6450
12	Clear Hose 5/8" ID (Per Foot)	ALL	HXLA
13	Drain Sub Assembly with Valve ("AX" Cylinder)	H_AJ	H-690-0542
13	Drain Sub Assembly with Valve ("B" Cylinder)	H_DJ	H-690-0543
13	Drain Sub Assembly with Valve ("C" Cylinder)	H_GJ	H-690-0544
13	Drain Sub Assembly with Valve ("Dual" Cylinder) LH	H-HJ	H-690-0545
13	Drain Sub Assembly with Valve ("Dual" Cylinder) RH	H-HJ	H-690-0546
14	Terminal Connector with Wire ("AX" / "B" Cylinder)	H_AJ, H_DJ	H-690-3781
14	Terminal Connector with Wire ("C" Cylinder)	H_GJ, H-HJ	H-690-3161
15	Power Distribution Block	ALL	SEE TABLE
16	Current Sensing Transformer (Sub Assembly 1)	ALL (H-998-0097)	SEE TABLE
16	Current Sensing Transformer (Sub Assembly 3)	ALL (H-998-0098)	SEE TABLE
17	Door Interlock Switch	ALL	H-801-7801
18	Wire Harness ("AX" / "B" Cylinder)	H_AJ, H_DJ	H-998-6997
18	Wire Harness ("C" Cylinder)	H_GJ	H-998-6998
18	Wire Harness ("Dual" Cylinder)	H_HJ	H-998-6999
19	Drain Cup	ALL	H-999-5690

\* = Not Shown

**Table 2**

Model	Max. Lb./ Hr.	Ph.	Volts	Steam Cylinder	Power Transformer	Contactora	Terminal Connector with Wire*	Circuit Breaker	Power Distribution Block	Current Sensing Transformer
H_AJA	5	1	120	AX220	998-9537	999-7389	690-3781	999-7406	999-8035	998-0097
H_AJB	5	1	208	AX380	998-9537	999-7389	690-3781	999-7405	999-8035	998-0097
H_AJD	5	1	230	AX380	998-9537	999-7389	690-3781	999-7406	999-8035	998-0097
H_AJF	5	1	277	AX380	998-9535	999-7389	690-3781	999-7405	999-8035	998-0097
H_AJL	5	1	380	AX600	998-9535	999-7389	690-3781	999-7405	999-8035	998-0097

**Table 2 — Continued**

Model	Max. Lb./ Hr.	Ph.	Volts	Steam Cylinder	Power Transformer	Contactors	Terminal Connector with Wire*	Circuit Breaker	Power Distribution Block	Current Sensing Transformer
H_AJQ	5	1	415	AX600	998-9535	999-7389	690-3781	999-7405	999-8035	998-0097
H_AJM	5	1	460	AX700	998-9537	999-7389	690-3781	999-7405	999-8035	998-0097
H_AJN	5	1	575	AX700	998-9539	999-7389	690-3781	999-7412	999-8035	998-0097
H_AJA	10	1	120	AX220	998-9537	999-7480	690-3781	999-7409	999-8035	998-0097
H_AJB	10	1	208	AX380	998-9537	999-7389	690-3781	999-7407	999-8035	998-0097
H_AJD	10	1	230	AX380	998-9537	999-7389	690-3781	999-7407	999-8035	998-0097
H_AJF	10	1	277	AX380	998-9535	999-7389	690-3781	999-7406	999-8035	998-0097
H_AJL	10	1	380	AX600	998-9535	999-7389	690-3781	999-7405	999-8035	998-0097
H_AJQ	10	1	415	AX600	998-9535	999-7389	690-3781	999-7405	999-8035	998-0097
H_AJM	10	1	460	AX700	998-9537	999-7389	690-3781	999-7405	999-8035	998-0097
H_AJN	10	1	575	AX700	998-9539	999-7389	690-3781	999-7412	999-8035	998-0097
H_DJB	20	1	208	B381	998-9537	999-7480	690-3781	999-7410	999-8035	998-0097
H_DJD	20	1	230	B381	998-9537	999-7480	690-3781	999-7409	999-8035	998-0097
H_DJF	20	1	277	B381	998-9535	999-7389	690-3781	999-7409	999-8035	998-0097
H_DJL	20	1	380	B600	998-9535	999-7389	690-3781	999-7408	999-8035	998-0097
H_DJQ	20	1	415	B600	998-9535	999-7389	690-3781	999-7407	999-8035	998-0097
H_DJM	20	1	460	B700	998-9537	999-7389	690-3781	999-7406	999-8035	998-0097
H_DJN	20	1	575	B700	998-9539	999-7389	690-3781	999-7412	999-8035	998-0097
H_DJC	20	3	208	B500	998-9537	999-7389	690-3781	999-7407	999-8035	998-0097
H_DJE	20	3	230	B500	998-9537	999-7389	690-3781	999-7407	999-8035	998-0097
H_DJT	20	3	380	B600	998-9535	999-7389	690-3781	999-7405	999-8035	998-0097
H_DJW	20	3	415	B600	998-9535	999-7389	690-3781	999-7405	999-8035	998-0097
H_DJG	20	3	460	B700	998-9537	999-7389	690-3781	999-7405	999-8035	998-0097
H_DJH	20	3	575	B700	998-9539	999-7389	690-3781	999-7412	999-8035	998-0097
H_DJC	30	3	208	B500	998-9537	999-7480	690-3781	999-7409	999-8035	998-0097
H_DJE	30	3	230	B500	998-9537	999-7389	690-3781	999-7409	999-8035	998-0097
H_DJT	30	3	380	B600	998-9535	999-7389	690-3781	999-7407	999-8035	998-0097
H_DJW	30	3	415	B600	998-9535	999-7389	690-3781	999-7406	999-8035	998-0097
H_DJG	30	3	460	B700	998-9537	999-7389	690-3781	999-7406	999-8035	998-0097
H_DJH	30	3	575	B700	998-9539	999-7389	690-3781	999-7412	999-8035	998-0098
H_GJB*	30	1	208	C62	998-9537	999-7389 (2)	690-3781	999-7290	999-8035	998-0097(2)
H_GJD	30	1	230	C62	998-9537	999-7480	690-3161	999-7411	999-8035	998-0097
H_GJF	30	1	277	C62	998-9535	999-7480	690-3161	999-7410	999-8035	998-0097
H_GJL	30	1	380	C62	998-9535	999-7480	690-3161	999-7409	999-8035	998-0097
H_GJQ	30	1	415	C62	998-9535	999-7389	690-3781	999-7409	999-8035	998-0097
H_GJM	30	1	460	C62	998-9537	999-7389	690-3781	999-7408	999-8035	998-0097
H_GJN	30	1	575	C62	998-9539	999-7389	690-3781	999-7414	999-8035	998-0097
H_GJC	40	3	208	C62	998-9537	999-7480	690-3161	999-7411	999-8035	998-0098
H_GJE	40	3	230	C62	998-9537	999-7480	690-3161	999-7410	999-8035	998-0098
H_GJT	40	3	380	C65	998-9535	999-7389	690-3781	999-7408	999-8035	998-0098
H_GJW	40	3	415	C65	998-9535	999-7389	690-3781	999-7408	999-8035	998-0098
H_GJG	40	3	460	C65	998-9537	999-7389	690-3781	999-7407	999-8035	998-0098

\*H-690-3781 INCLUDES #10 WIRE.  
H-690-3161 INCLUDES #8 WIRE.

\* = Circuit Breaker is REQUIRED per NEC 48 amp guidelines.

**Table 2 — Continued**

Model	Max. Lb./Hr.	Ph.	Volts	Steam Cylinder	Power Transformer	Contactors	Terminal Connector with Wire*	Circuit Breaker	Power Distribution Block	Current Sensing Transformer
H_GJH	40	3	575	C65	998-9539	999-7389	690-3781	999-7413	999-8035	998-0098
H_GJC	50	3	208	C62	998-9537	999-7389 (2)	690-3781	999-7409 (2)	999-8035	998-0098
H_GJE	50	3	230	C62	998-9537	999-7480	690-3161	999-7411	999-8035	998-0098
H_GJT	50	3	380	C65	998-9535	999-7480	690-3161	999-7409	999-8035	998-0098
H_GJW	50	3	415	C65	998-9535	999-7389	690-3781	999-7409	999-8035	998-0098
H_GJG	50	3	460	C65	998-9537	999-7389	690-3781	999-7408	999-8035	998-0098
H_GJH	50	3	575	C65	998-9539	999-7389	690-3781	999-7414	999-8035	998-0098
H_GJC*	60	3	208	C62	998-9537	999-7480 (2)	690-3161	999-7291 (2)	999-8035	998-0098 (2)
H_GJE*	60	3	230	C62	998-9537	999-7389 (2)	690-3781	999-7291 (2)	999-8035	998-0098 (2)
H_GJT	60	3	380	C65	998-9535	999-7480	690-3161	999-7410	999-8035	998-0098
H_GJW	60	3	415	C65	998-9535	999-7480	690-3161	999-7409	999-8035	998-0098
H_GJG	60	3	460	C65	998-9537	999-7389	690-3781	999-7409	999-8035	998-0098
H_GJH	60	3	575	C65	998-9539	999-7389	690-3781	999-7414	999-8035	998-0098
H_GJC*	80	3	208	C62	998-9537	999-7480 (2)	690-3161	999-7293 (2)	999-8035	998-0098 (2)
H_GJE*	80	3	230	C62	998-9537	999-7480 (2)	690-3161	999-7292 (2)	999-8035	998-0098 (2)
H_GJT	80	3	380	C12	998-9535	999-7480	690-3161	999-7411	999-8035	998-0098
H_GJW	80	3	415	C12	998-9535	999-7480	690-3161	999-7411	999-8035	998-0098
H_GJG	80	3	460	C12	998-9537	999-7480	690-3161	999-7410	999-8035	998-0098
H_GJH	80	3	575	C12	998-9539	999-7389	690-3781	999-7415	999-8035	998-0098
H_GJC*	100	3	208	C62	998-9537	999-7480 (2)	690-3161	999-7293 (2)	999-8035	998-0098 (2)
H_GJE*	100	3	230	C62	998-9537	999-7480 (2)	690-3161	999-7293 (2)	999-8035	998-0098 (2)
H_GJT*	100	3	380	C12	998-9535	999-7389 (2)	690-3161	Contact Factory	999-8035	998-0098 (2)
H_GJW	100	3	415	C12	998-9535	999-7389 (2)	690-3781	999-7409 (2)	999-8035	998-0098 (2)
H_GJG	100	3	460	C12	998-9537	999-7480	690-3161	999-7411	999-8035	998-0098
H_GJH	100	3	575	C12	998-9539	999-7480	690-3161	999-7416	999-8035	998-0098
H_HJC*	125	3	208	C62 (2)	998-9537	999-7480 (4)	690-3161	999-7291 (4)	999-8035	998-0098 (4)
H_HJE*	125	3	230	C62 (2)	998-9537	999-7480 (4)	690-3161	999-7291 (4)	999-9524	998-0098 (4)
H_HJT*	125	3	380	C12 (2)	998-9535	999-7480 (2)	690-3161	999-7416 (2)	999-8035	998-0098 (2)
H_HJW*	125	3	415	C12 (2)	998-9535	999-7480 (2)	690-3161	999-7416 (2)	999-8035	998-0098 (2)
H_HJG*	125	3	460	C12 (2)	998-9537	999-7480 (2)	690-3161	999-7415 (2)	999-8035	998-0098 (2)
H_HJH	125	3	575	C12 (2)	998-9539	999-7389 (2)	690-3781	999-7414 (2)	999-8035	998-0098 (2)
H_HJC*	150	3	208	C62 (2)	998-9537	999-7480 (4)	690-3161	999-7292 (4)	999-9524	998-0098 (4)
H_HJE*	150	3	230	C62 (2)	998-9538	999-7480 (4)	690-3161	999-7292 (4)	999-9524	998-0098 (4)
H_HJT*	150	3	380	C12 (2)	998-9535	999-7480 (2)	690-3161	999-7416 (2)	999-8035	998-0098 (2)
H_HJW*	150	3	415	C12 (2)	998-9535	999-7480 (2)	690-3161	999-7416 (2)	999-8035	998-0098 (2)
H_HJG*	150	3	480	C12 (2)	998-9537	999-7480 (2)	690-3161	999-7415 (2)	999-8035	998-0098 (2)
H_HJH*	150	3	575	C12 (2)	998-9539	999-7389 (2)	690-3781	999-7414 (2)	999-8035	998-0098 (2)
H_HJC*	175	3	208	C62 (2)	998-9537	999-7480 (4)	690-3161	999-7293 (4)	999-9524	998-0098 (4)
H_HJE*	175	3	230	C62 (2)	998-9537	999-7480 (4)	690-3161	999-7293 (4)	999-9524	998-0098 (4)
H_HJT*	175	3	380	C12 (2)	998-9535	999-7480 (4)	690-3161	Contact Factory	999-9524	998-0098 (4)

\* = Circuit Breaker is REQUIRED per NEC 48 amp guidelines.

**Table 2 — Continued**

Model	Max. Lb./Hr.	Ph.	Volts	Steam Cylinder	Power Transformer	Contactors	Terminal Connector with Wire*	Circuit Breaker	Power Distribution Block	Current Sensing Transformer
H_HJW*	175	3	415	C12 (2)	998-9535	999-7480 (2)	690-3161	999-7416 (2)	999-9524	998-0098 (2)
H_HJG*	175	3	460	C12 (2)	998-9537	999-7480 (2)	690-3161	999-7415 (2)	999-8035	998-0098 (2)
H_HJH*	175	3	575	C12 (2)	998-9539	999-7480 (2)	690-3161	999-7416 (2)	999-8035	998-0098 (2)
H_HJC*	200	3	208	C62 (2)	998-9537	999-7480 (4)	690-3161	999-7293 (4)	999-9524	998-0098 (4)
H_HJE*	200	3	230	C62 (2)	998-9537	999-7480 (4)	690-3161	999-7293 (4)	999-9524	998-0098 (4)
H_HJT*	200	3	380	C12 (2)	998-9535	999-7480 (4)	690-3161	Contact Factory	999-9524	998-0098 (4)
H_HJW*	200	3	415	C12 (2)	998-9535	999-7480 (4)	690-3161	Contact Factory	999-9524	998-0098 (4)
H_HJG*	200	3	460	C12 (2)	998-9537	999-7480 (2)	690-3161	999-7417 (2)	999-8035	998-0098 (2)
H_HJH*	200	3	575	C12 (2)	998-9539	999-7480 (2)	690-3161	999-7416 (2)	999-8035	998-0098 (2)

\* = Circuit Breaker is REQUIRED per NEC 48 amp guidelines.

**CIRCUIT BOARD** (Table 3)

